



Anti-Ligature Wall Mounted Stainless Steel Shelf

Datasheet

Code: 145772

Construction

Ø19.05 x 1.6mm Stainless Steel tube frame
2mm thick Stainless Steel shelf, sides, and wall plates, fully welded to frame forming a unified structure.

15x 6.50 Mounting holes.

Glass Bead Blast Satin Finish.

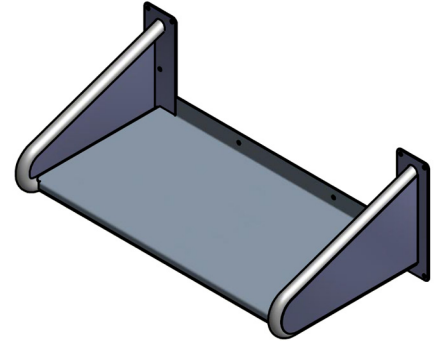

Installation

Use shelf as template for locating all [15] mounting holes.

Conformity and compliance to local and national codes is the responsibility of the installer. Shelf is only as strong as the anchoring devices and the wall on which it is mounted. Adequate in-wall backing may be required.

Tamper resistant security sealant must be used on all wall gaps.

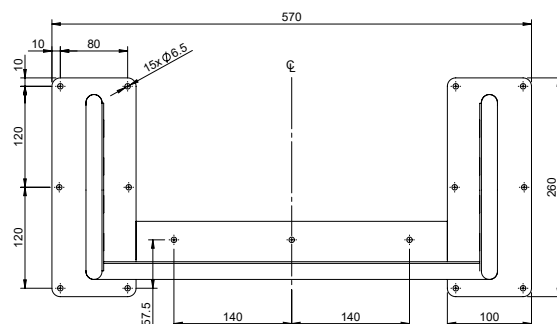
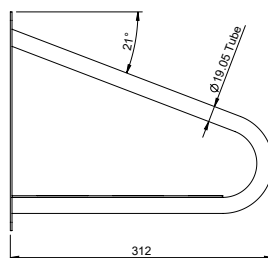
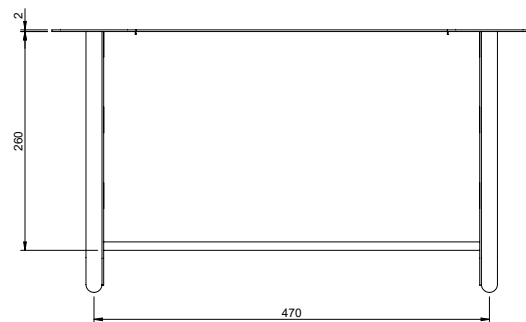
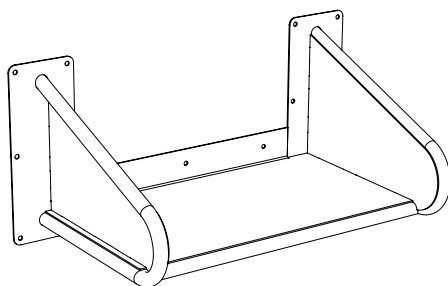

ABOUT HIPAC

We are an Australian healthcare company that guarantees to stand behind all our medical products, both manufactured and imported, because we're here for the life of our products and clients.

PO Box 797, 36 Long St. Goulburn NSW 2580, Australia

P. +61 2 4823 0000 E. info@hipac.com.au

SYDNEY | MELBOURNE | BRISBANE | ADELAIDE | PERTH

hipac.com.au

ABN 27 600 353 688