

# Mental Health Bed - Sand Filled and Floor Mounted



## Table of Contents

Sand Filled Installation	1
Floor Mounted Installation	3

## Sand Filled Installation

Items for Installation	
Supplied	
1 x Mental Health Bed (Roto-moulded)	6 x Heavy duty cable ties
2 x Sand cavity lids (Roto-moulded)	12 x M8 x 60mm Stainless button head Torx screws
6 x 20kg Polypropylene bags	12 x M8 Stainless washers
Required	
120kg of washed plaster sand	Torx head screw driver
<b>Required Personnel</b>	2

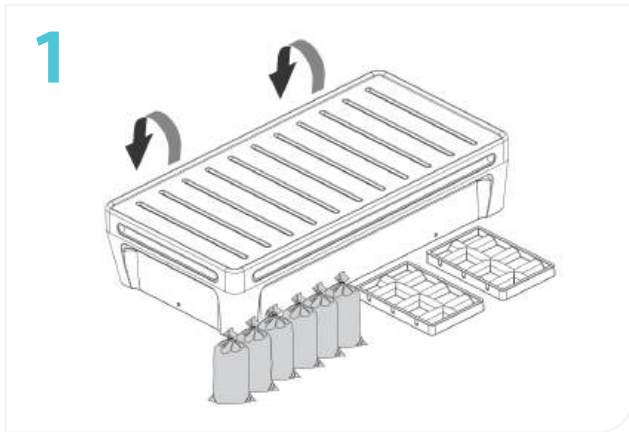

1. Place the bed roughly in its final position. Flip the bed over so that the bottom cavity of the bed is exposed.

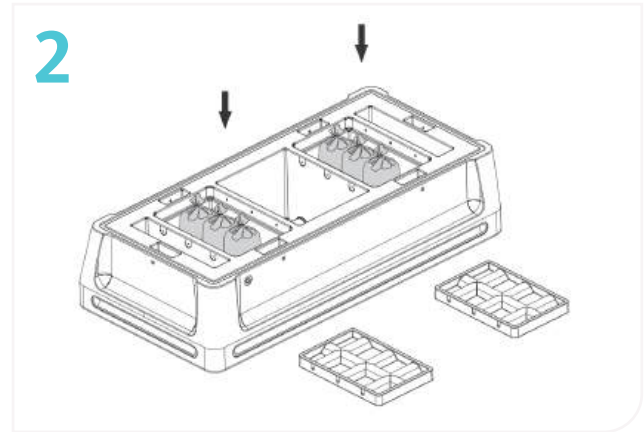

2. Fill each of the polypropylene bags with 20kgs of sand and close the top of the bag with a heavy duty cable tie. Place 3 sand filled bags each into the 2 cavities indicated above.

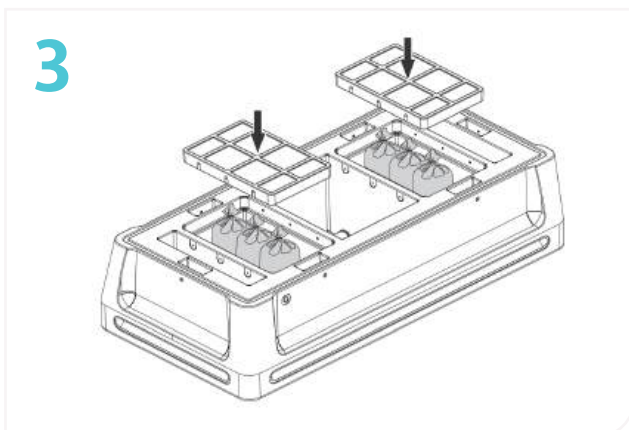

3. Place the sand cavity lids into the cavities with the surface shown above facing the base of the bed. The sand cavity lids must be placed onto the lip on the inside of the cavity, once in position the surface of the lid and bed base must be flush.

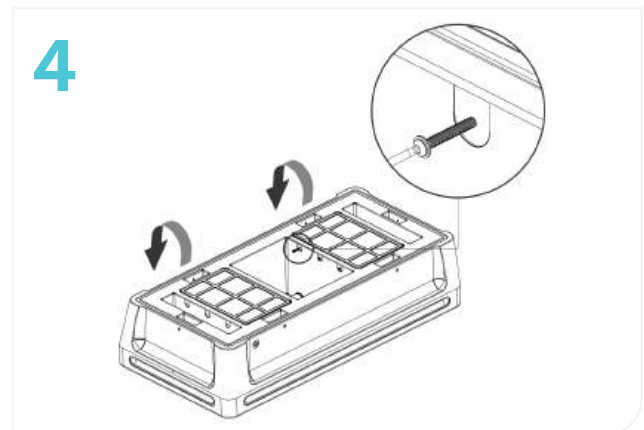

4. Insert and tighten the M8 x 60mm Stainless button head Torx security screws to secure the sand within the cavity. Flip the bed back over so that the mattress platform is now back on top. This step will require 2 people.

## Floor Mounted Installation

Items for Installation	
Supplied	
1 x Mental Health Bed (Roto-moulded)	12 x M6 x 60mm Nail in anchors
1 x Cardboard mounting template	6 x M8 x 80mm Stainless button head Torx screws
6 x Floor mounting brackets	6 x M8 Stainless washers
Required	
Impact drill	Hammer
8mm Masonry drill bit	Torx head screw driver
Required Personnel	2

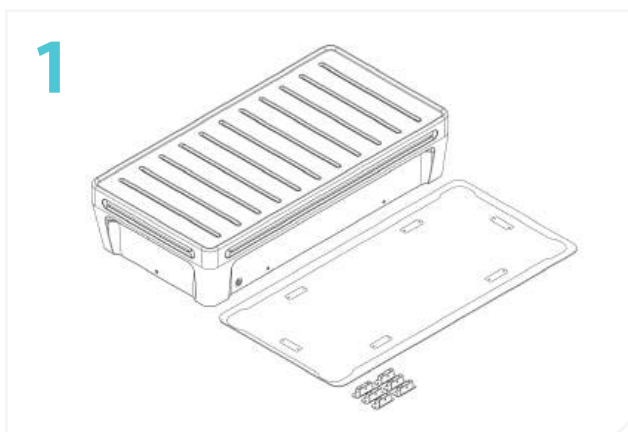

1. Unbox the bed, cardboard mounting template and all hardware included in the box.

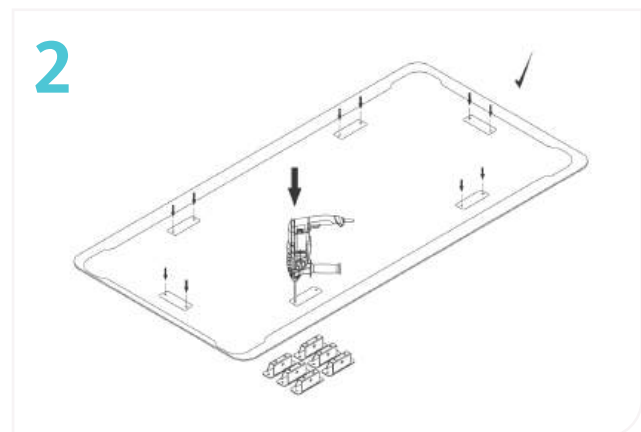

2. Place the cardboard mounting template in the intended final position of the bed. Using an 8mm masonry drill bit, drill the mounting points marked on the template to a depth of 65mm. Ensure the holes are dust free once drilled.

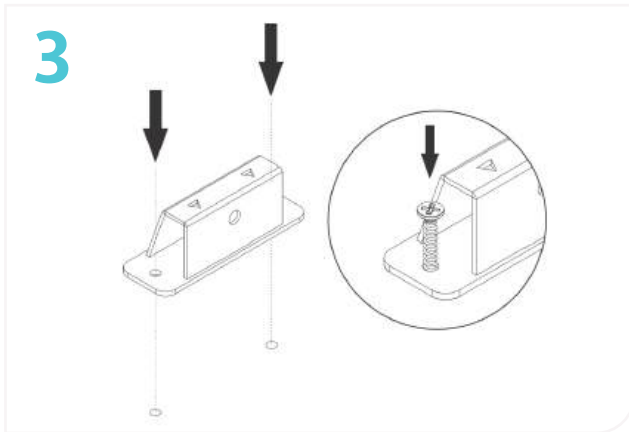

3. Remove the cardboard template. Insert the M6 nail in anchor plugs into the holes drilled in Step 2. Align the holes of the floor mounting bracket with the holes, ensuring that the arrows on top of the bracket are facing towards the outside of the bed's final position. Secure the bracket to the floor using the M6 nail in anchors.

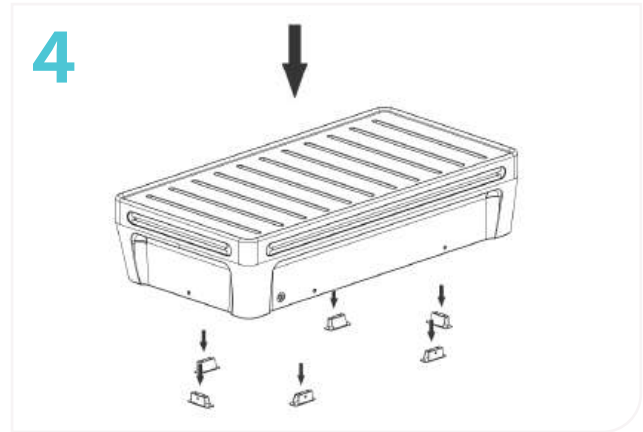

4. Once the floor mounting brackets are all secured in position, carefully lower the bed onto the brackets. The brackets will locate into the mounting cavities on the base of the bed ensuring that the bed is in the correct position. This step will require 2 people.

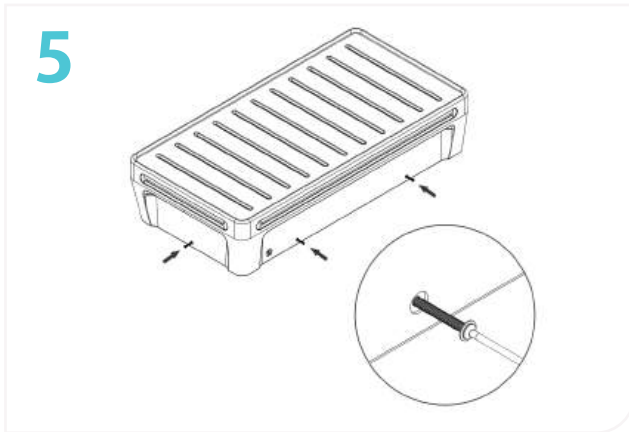

5. Once the bed is in its final position, insert a M8 x 80mm button head Torx screw into the hole on the side of the side indicated above. Secure the screw through the bed in to the mounting bracket to fasten the bed into position.

#### Disclaimer:

All products must be fitted as per the directions detailed in the individual product Installation Instruction Document. Hipac takes no responsibility for incorrect installation/operation of the product. By purchasing this product, you are confirming that the product will be fitted as per the instructions.

Please note that Hipac offers a range of measures designed to reduce the risk of self-harm or suicide and does not offer any guarantee that it will not take place. The solutions have been designed as a deterrent only.

#### ABOUT HIPAC

Operating at the forefront of healthcare, we strive to redefine what's possible. We provide superior products, design expertise and total solutions to help create environments where nothing stands in the way of patient care.

##### Contact information



1800 75 93 93



[info@hipac.com.au](mailto:info@hipac.com.au)



[www.hipac.com.au](http://www.hipac.com.au)

 **Hipac**  
We're here for life